







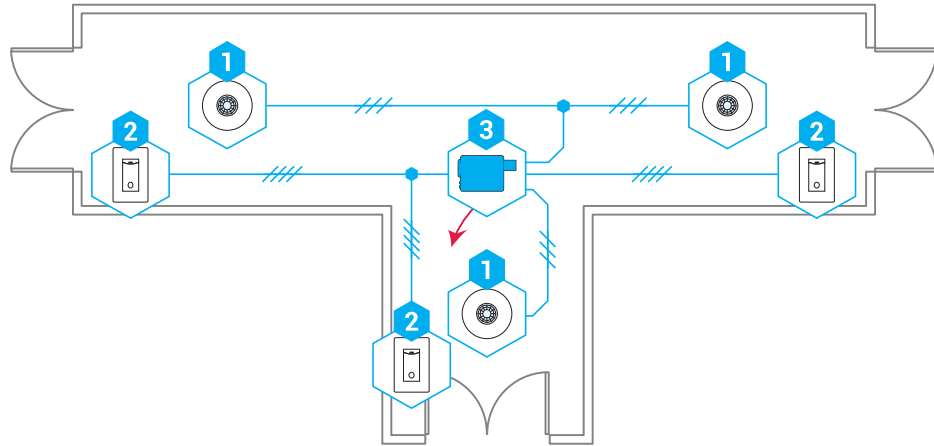

## KEY

-  TO LINE VOLTAGE CONNECTIONS
-  LOW VOLTAGE WIRING (18 AWG)



## BILL OF MATERIAL

DIAGRAM #	QTY	MODEL #	DESCRIPTION
	3	<b>SWX-202-1</b>	PIR Occupancy Sensor, Large Motion, Ceiling Mount 360°
	3	<b>SWX-801-xx</b>	On/Off Wall Switch - Low Voltage, <xx = color>
	1	<b>SWX-900-AX</b>	Power Pack w/ Auxiliary Switch Input, 120/277 VAC

## SEQUENCE OF OPERATION

1. Lighting switched on automatically to full bright.
2. On/off manual control of lighting.
3. Lighting turns off automatically after occupants leave the space.

## ADDITIONAL DESIGN CONSIDERATIONS

1. In long corridors, add additional ceiling sensors every 40 ft as needed.
2. Alternative hallway sensor (at ends of corridor) model **SWX-402-1**.

## SUPPORTED CODE REQUIREMENTS

Occupancy Sensor Control  
**C405.2.1 & C405.2.1.1(1)**

Manual Control - Switch  
**C405.2.2.3**

Auto On to Full Allowed  
**C405.2.1.1.(2)**