

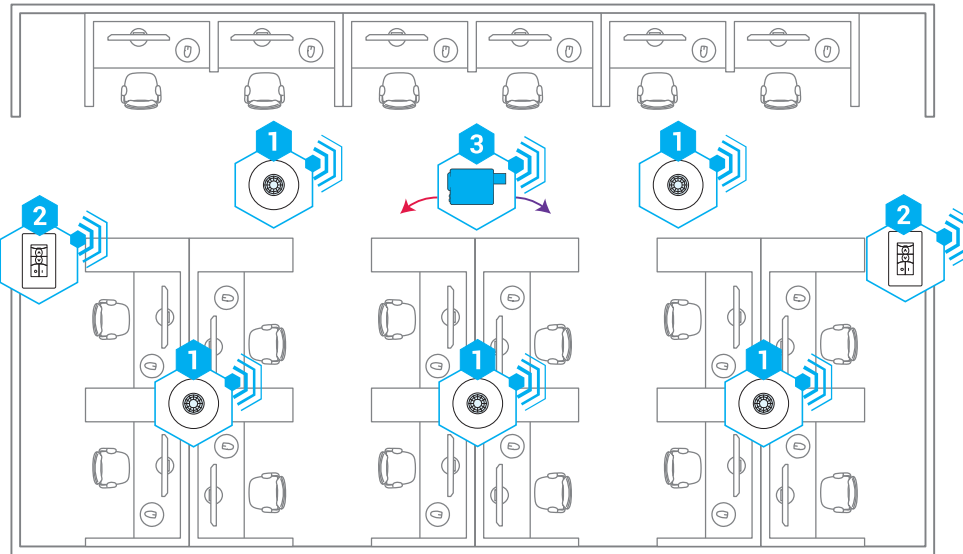





WIRELESS



KEY

-  TO LINE VOLTAGE CONNECTIONS
-  TO 0-10V LIGHTING
-  WIRELESS CONNECTION

BILL OF MATERIAL

DIAGRAM #	QTY	MODEL #	DESCRIPTION
1	5	SWX-221-B	Wireless Dual Technology (PIR/Acoustic) Occupancy Sensor, Small Motion, Ceiling Mount 360°
2	2	SWX-854-B-xx	Wireless Remote Dimming Wall Station (0-10V), <xx = color>
3	1	SWX-950-D2	Wireless Power Pack w/ Dimming (0-10V), 120/277 VAC

SEQUENCE OF OPERATION

1. Lighting switched on manually to last user level or automatically to 50% upon occupancy.
2. On/off & raise/lower control of each lighting zone via separate dimmer switches.
3. All lighting zones turn off automatically after occupants leave the space.

ADDITIONAL DESIGN CONSIDERATIONS

1. Maximum lighting levels can be task tuned to increase energy savings.
2. Increase number of control zones by adding **SWX-950-D2** and **SWX-854-B-xx** units.

SUPPORTED CODE REQUIREMENTS

Occupancy Sensor Control
C405.2.1 & C405.2.1.1(1)

Manual Control - Switch
C405.2.2.3

Manual On-Off/Partial Auto On
C405.2.1.1

Manual Light Reduction Control - Dimmer
C405.2.2.2*

*RECOMMENDED BUT NOT REQUIRED BY CODE